

# SYSTEM 300 LOADING INSTRUCTIONS



## STEP 1

Open the dispenser using the key



## STEP 2

Remove the cartridge cap by squeezing each side

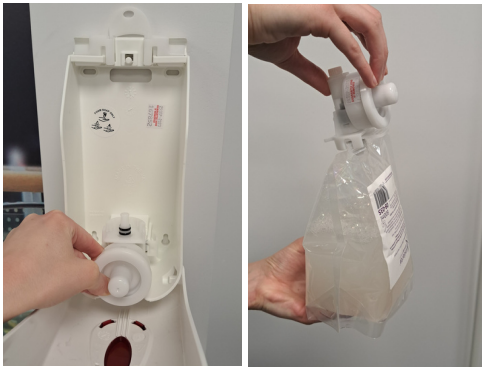

## STEP 3

Slide the pump out of the dispenser and slot on the top of cartridge



## STEP 4

Turn upside down and ease the pouch into the dispenser

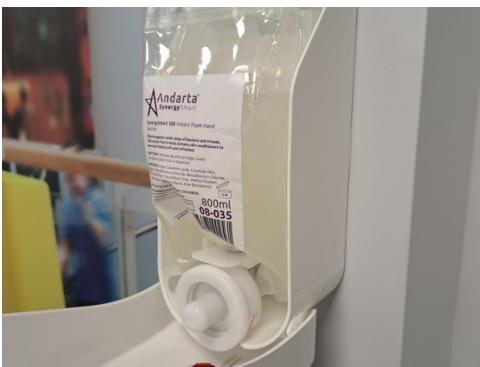

## STEP 5

Push down until the pump clicks into place



## STEP 6

Shut the dispenser front